

溯光 Surglite

Portable House Introduction Manual

集成房屋 简介手册



HOUSE

溯光
Surglite

品牌理念
BRAND PHILOSOPHY

Nice House Easy Life



Catalogue

目录

| 03 实力
PRODUCT

Landing Project Display

| 01 品牌
BRAND

- ① Strategic layout
- ② Factory Profile
- ③ Transport Installation
- ④ Product Advantages
- ⑤ Application Scenarios

| 02 产品
PRODUCT

- ① E Series
- ② F Series
- ③ Space Capsule series
- ④ Expandable Container Series
- ⑤ Custom Container

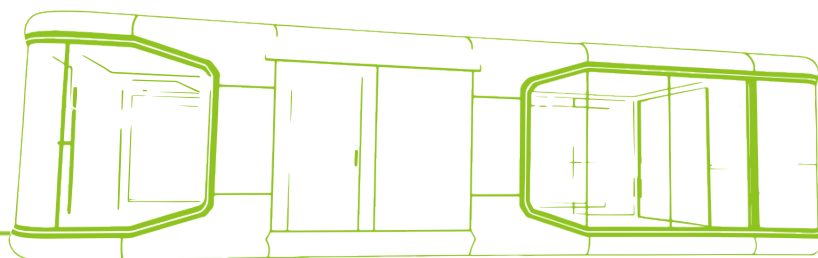



Its products are sold at home and abroad, with a cumulative cooperation of more than 160 countries, providing services for more than 30,000 customers around the world, with a cumulative production of 30 million square meters and an average annual sales of more than 600 million yuan. At present, it is the largest and most complete company in the industry.

Factory Profile

We are determined to build a benchmark brand in China's mobile housing industry, relying on standardized regional center factories in many places across the country (covering Anhui, Jiangsu, Sichuan, Guangdong and other core economic belts), through a distributed manufacturing network to achieve rapid response nearby. We use international advanced intelligent equipment to build a standardized assembly line, implement a full-process digital management and control system, and realize an agile supply system with a service radius of 700 kilometers across the country while ensuring the accuracy of product technology.

Each regional center factory implements unified production standards and process specifications, and realizes cross-regional capacity synergy through a modular manufacturing system. This innovative model of "regional factory + standard technology" not only ensures the stability of product quality, but also provides 24-hour response to localized services for customers around the world. In the future, we will continue to expand the global joint manufacturing base and build a more complete near-field service system.



溯光
Surglite

运输与安装
TRANSPORTATION AND INSTALLATION



Transportation & Installation

When traditional buildings are still in the game with reinforced concrete, we choose to reshape space migration with aerospace thinking – each capsule is prefabricated with precision instrument standards, from keel welding, pipeline pre-embedding to intelligent central control commissioning, and factory-level standardized production. The encapsulated capsule is accurately delivered to the mountains, rivers, lakes and seas through special logistics vehicles. Arriving at the destination, the heavy crane will be set up, and it will only take a few hours from lifting to the ground to connecting electricity and water.

From the factory to the time and space folding of the secret realm of mountains and seas, Yiqi protects the wild nature with industrial precision. Whether it's an eco-camp, a starry sky homestay or a private art gallery, you'll see a future home leap from a conceptual blueprint to reality.

溯光
Surglite

产品优势
PRODUCT ADVANTAGES



预制型房屋



土地性质
要求宽松



文旅生态开发



投资门槛低



品牌优选

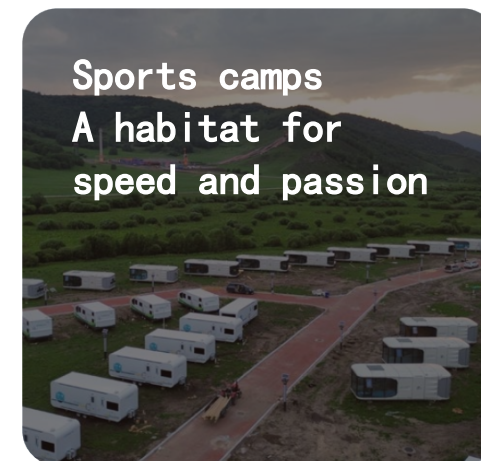

E系列 SERIES

HOUSE

溯光
Surglite

产品简介
PRODUCT INTRODUCTION



E3-II

整体尺寸
5.6*2.6*3.2m

建筑面积
14.6 m²

The E series exquisite unit adopts the general design language of the E series, and the angular design of the aviation aluminum shell is matched with line painting, which is full of science and technology and a sense of the future. The horizontal layout has a large field of view and a panoramic sunroof at the top. There are dry and wet separated toilets, which can be used for large beds, twin beds, studios and other room types, with high expansibility.

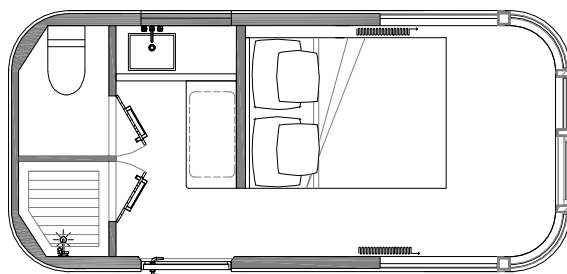

E3-II 平面布局图
— PLANE LAYOUT —



E5-II

整体尺寸
8.5*3.2*3.2m

建筑面积
27.2 m²

The E series of popular products, using the E series aviation aluminum shell angular design with line painting design language, 360 ° panoramic view of the lake, starlight canopy, cabin constant temperature and sound insulation. The whole house is equipped with smart home appliances, with a large indoor area and a service life of more than 50 years.

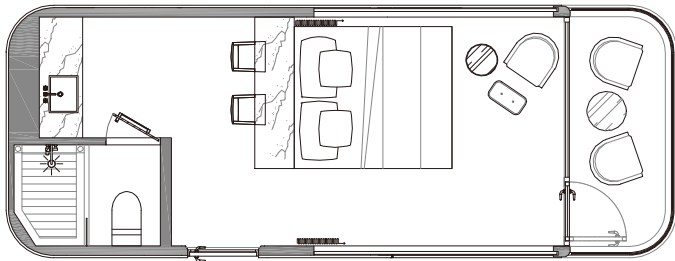

E5-II 平面布局图
— PLANE LAYOUT —



E6-II

整体尺寸
8.5*3.2*3.2m

建筑面积
27.2 m²

The E series two-bedroom landscape room adopts the design language of the E series aviation aluminum shell with the angular design of the line painting, and is equipped with floor-to-ceiling windows with a total of 270° views on three sides. The internal structure is cleverly divided into two separate rooms, with the main and secondary bedrooms and the living room being available at will.

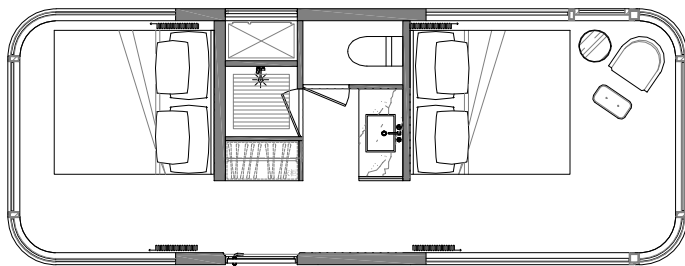

E6-II 平面布局图
— PLANE LAYOUT —



E7-II

整体尺寸
11.5*3.3*3.2m

建筑面积
38 m²

The flagship and popular product of the E series. It adopts the E-series universal design language and can reach a length of 11.5 m. It continues the high space utilization rate of the E series, with a standard layout of one bedroom, one living room and one bathroom, and the perfect functional layout can meet the needs of long-term living. The large space layout can also meet more customized solutions.

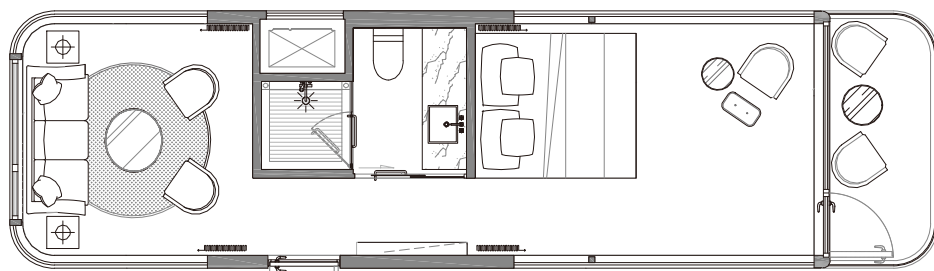

E7-II 平面布局图

— PLANE LAYOUT —



F系列 SERIES

HOUSE

F3

整体尺寸
5.6*2.8*3.1m

建筑面积
15.7 m²

The F series can be equipped with a terrace, and the indoor configuration is equipped with a dry and wet separation toilet, which can be used as a large bed, tea room, studio and other room types, and can also be used as a scenic homestay for a long time to meet the needs of diversified travel experience.

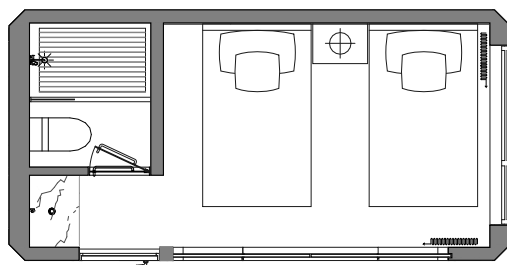

F3 平面布局图
— PLANE LAYOUT —

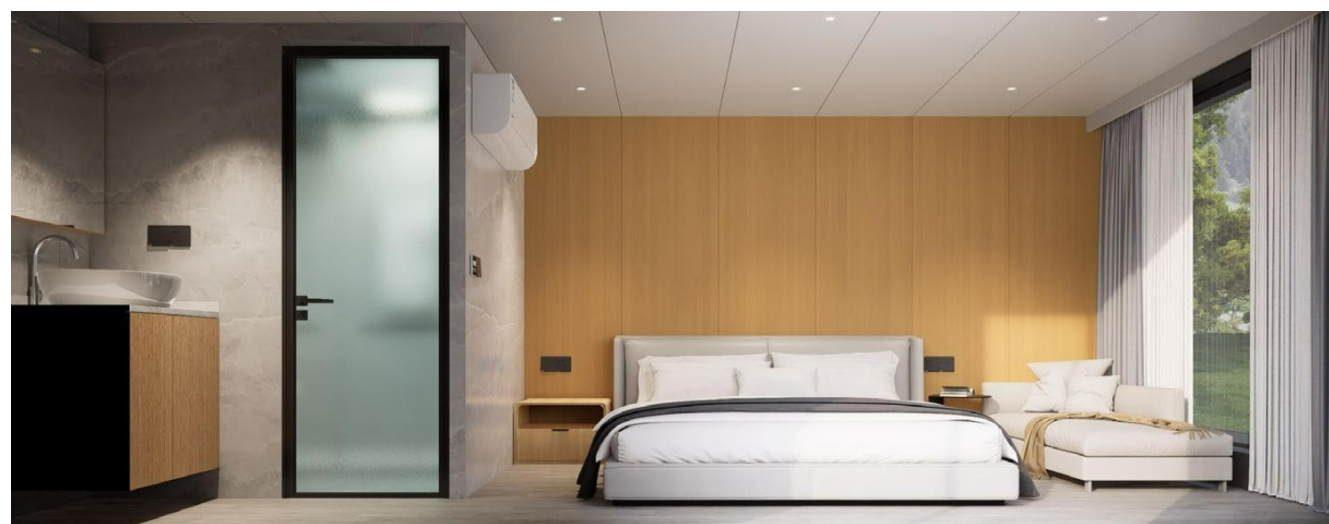

F5

整体尺寸
9.5*3.2*3.2m

建筑面积
30.4 m²

The F series has a large interior space, an open kitchen and a bar counter design, which increases the interactive interest and shows a more modern atmosphere. Panoramic floor-to-ceiling glass windows, mountains and lakes are in view, and the sunset is in full view, enjoying the fun of nature.

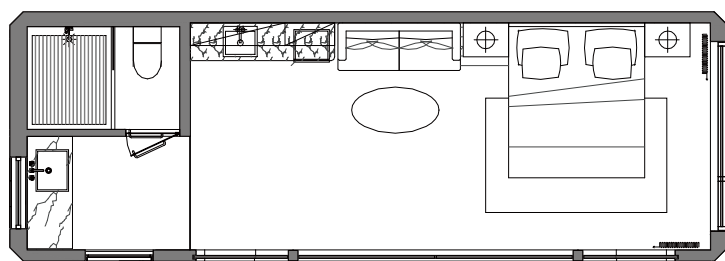

F5 平面布局图
— PLANE LAYOUT —



F7

整体尺寸
11.5*3.2*3.2m

建筑面积
36.8 m²

The exterior design of the F series abandons complicated decoration and adopts a simple and elegant exterior design, which realizes the perfect combination of modern aesthetics and practical functions. More than just a living space, it is the perfect combination of modern aesthetics and practical function, which can be harmoniously integrated into any environment, whether it is the hustle and bustle of the city or the tranquility of nature.

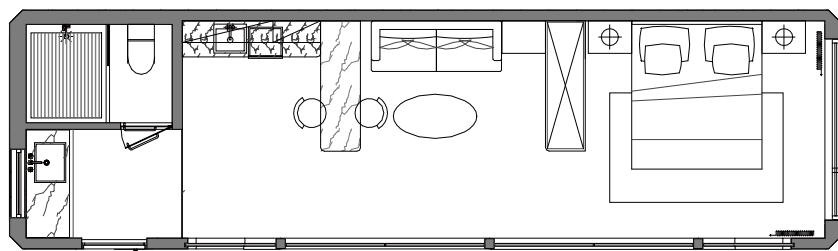

F7 平面布局图
— PLANE LAYOUT —



太空舱系列
微栖人居版
SPACE CAPSULE SERIES

HOUSE



A3

整体尺寸(长*宽*高)
5.6*2.8*3.1m | 建筑面积
15.7 m²

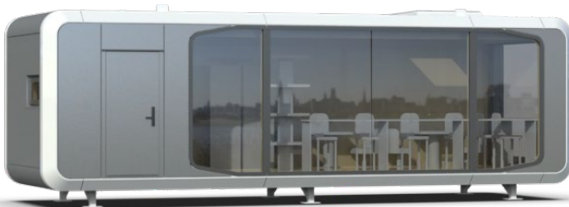

A5

整体尺寸(长*宽*高)
9.5*3.3*3.3m | 建筑面积
31.4 m²



A7

整体尺寸(长*宽*高)
11.5*3.3*3.3m | 建筑面积
38 m²



A7

服务中心

整体尺寸(长*宽*高)
11.5*3.3*3.3m | 建筑面积
38 m²



A9

整体尺寸(长*宽*高)
13.5*3.3*3.3m | 建筑面积
44.6 m²



A9

商铺版

整体尺寸(长*宽*高)
13.5*3.3*3.3m | 建筑面积
44.6 m²

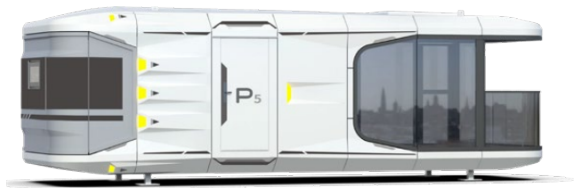

P5

整体尺寸(长*宽*高)
9.5*3.3*3.2m

建筑面积
31.4 m²

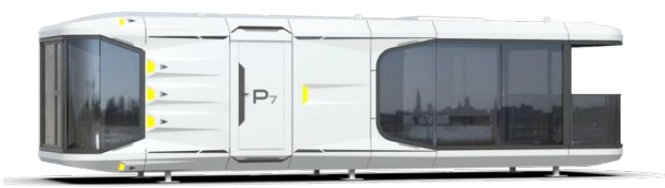

P7

整体尺寸(长*宽*高)
11.5*3.3*3.2m

建筑面积
38 m²



P9

整体尺寸(长*宽*高)
13.5*3.3*3.3m

建筑面积
44.6 m²



F7

整体尺寸(长*宽*高)
11.5*3.3*3.3m

建筑面积
38 m²

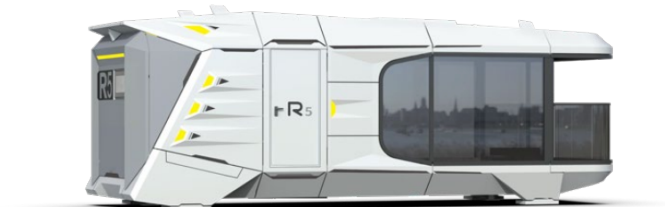

R5

整体尺寸(长*宽*高)
9.1*3.3*3.4m

建筑面积
30 m²



R7

整体尺寸(长*宽*高)
11.5*3.3*3.4m

建筑面积
38 m²



H5

整体尺寸(长*宽*高)
9.1*3.3*3.4m

建筑面积
30 m²



Z5

整体尺寸(长*宽*高)
9.5*3.3*3.2m

建筑面积
31.4 m²



Z7

整体尺寸(长*宽*高)
11.5*3.3*3.2m

建筑面积
38 m²



拆装款

AE23

整体尺寸(长*宽*高)
6.5*3.48*3.3m

建筑面积
23 m²



拆装款

AE31

整体尺寸(长*宽*高)
8.94*3.48*3.3m

建筑面积
31.1 m²



拆装款

AE40

整体尺寸(长*宽*高)
11.38*3.48*3.3m

建筑面积
40 m²

- 1



Ceiling and bedroom wall material: aluminum

The wall material of the bathing area:
carbon crystal board
- 2



Bathroom wall material: bamboo charcoal
fiberboard
- 3



Shower floor material: black marble
- 4



Washbasin countertop material: rock slab
- 5



Handwashing Cabinet Material: Wooden
Cabinet
- 6



Bathing area floor material: tile
- 7



Bedroom floor material: wooden floor
- 8





拓展箱

EXPANDABLE
CONTAINER HOUSE

HOUSE

The new expansion box adopts a new type of aluminum alloy material, which effectively solves the problem of thermal insulation under severe cold conditions, and uses a new construction structure to maximize the internal use space.

Expansion container house can be used alone or combined, container house can be used to make small housing, bathroom, kitchen, laundry, small conference room, office space, small supermarket, etc., through the combination of design and assembly can be used as a relatively large conference room, villa-style residence, hospital, hotel, office building, etc.



家庭住宿



医疗站



别墅式住宅



办公室



度假村



咖啡厅

Military expansion containers

The project is located in Afghanistan. We have already supplied 120 military expansion boxes to the military. The product is generally used in shelters, war rooms, medical stations and barracks. It can be equipped with some advanced facilities and technical equipment inside, and has the characteristics of solid appearance and flexible movement, which is very popular with the military.



Mobile Medical Stations

These mobile health stations are located in Texas, United States. The project consists of 70 expansion boxes located in several different cities in Texas. It is flexible and portable, can be easily moved, and easily adapts to the needs of different locations and occasions. At the same time, its sustainability and environmental performance also help to reduce dependence on traditional energy sources, reduce operating costs, and have less negative impact on the environment.



Home or as a homestay or rental house

1. The internal area can be 27, 36, 54, 72 square meters;
2. The layout can add bathrooms, kitchens, bedrooms, rooftops, balconies, etc. ;
3. One house for multiple purposes.



溯光
Surglite

拓展箱系列
EXPANDABLE CONTAINER HOUSE



定制箱

CUSTOM CONTAINER

HOUSE

The styling advantage of the container commercial street lies in its uniqueness and individuality. As a building material, the container has a simple and modern appearance, giving people a fashionable and avant-garde feeling. The container theme commercial street can be a multi-functional, multi-business and multi-format commercial body that integrates shopping, catering, leisure, entertainment, culture and other functions, focusing on providing comprehensive services for consumers. The whole shopping street presents a theme together, which can meet the requirements of consumers for personalization, diversification and differentiation. Compared with traditional building materials, containers are less damaging to the environment, the construction time is shorter, and the shape is more plastic.



移动商业场景系列



应用场景：移动商铺 | 应用范围：各类特色餐车、创意集装箱、商品售卖亭、商业展厅等百余款产品。



应用场景：咖啡厅 | 应用范围：以景观性、功能性兼存的城市空间，产品40余款。



应用场景：景观设施 | 应用范围：各类IP 定制美陈、创息道具、互动亮化装置等近百款产品，营造差异化场景氛围，突显夜经济效果。



落地项目展示

DISPLAY OF LANDING
PROJECTS

HOUSE



溯光
Surglite

落地项目展示
DISPLAY OF LANDING PROJECTS

江西·九江·庐山西海













可见·泽栖帐篷艺术酒店

位于云南省西双版纳傣族自治州景洪市勐海县勐巴拉高尔夫度假区内，酒店目前紧邻悦椿spa，高尔夫球场。建筑师通过版纳特有的灵动生物幻化成一座座的现代帐篷酒店建筑。总面积13000m²，酒店一期为18间客房，两个户型“水映萤火”与“螺中洞天”。二期12间客房“蜂飞蝶舞”。



佛山市高明区高登国际广场营销中心项目



岭南集团肇庆市龙山景区接待中心项目



深圳茶博园项目



印尼星迈黎亚商业城项目



茂名乐彩田园项目



泰国集装箱小镇项目



广东佛山凌云花谷城市休闲度假区

项目面积：949.5亩（一期168.6亩）

出让土地面积：一期39.96亩

项目愿景：省级旅游度假区、国家AAAA级旅游景区

进度情况：项目一期已投入使用并成熟运营，计划2025年6月开始动工建设二期，年末完成二期建设，目前三期正在筹备中。



广东世纪星辉产业园项目



缅甸集装箱小镇项目



柬埔寨集装箱小镇项目



珠海星乐度模块化商业街



上海崇明岛模块化接待展示中心项目



广州黄麻村项目

溯光Surglite

HOUSE

轻 松 住 好 房

Nice House Easy Life



TEL: + 86 13966614580

致力成为模块化建筑行业标杆 · 让中国质造享誉全球
